

---

**ELECTROFUSION COUPLER PE100, SDR11****250mm Inner Diameter**

EF COUPLER PE100, SDR11 250mm Inner Diameter. For water, mining and irrigation applications. All fittings are manufactured in virgin PE100 white polyethylene. EF fittings enable utilities, designers and contractors to create fully welding pipe networks.

The production quality, reliability and flexibility of EF fittings provides the certainty and peace of mind needed for the PE pipe jointing.

**Product Description:**

EF 250mm for water, mining and irrigation applications. Water PN16.

Temperature range on EF fittings: -15°C/+40°C

**Design standards:**

※The Jiufeng Supplier co., have over 40 inland and international product approvals as well as ISO9001 quality management system approvals. GB/T13663.3-2018

※Gutuo branded electrofusion fittings are 3<sup>rd</sup> party certified against the products standards listed.

**GUTUO BRAND****Features:**

- ※GUTUO branded.
- ※PE 100 raw best quality choice.
- ※Water PN16 (Depending on PE pipe welded and any local pipeline pressure regulations).
- ※Full production tracking records and random inspection records.
- ※CNC wiring copper line, One-time molding.
- ※All EF fittings are individually numbered and the barcodes and QR code full individual fitting traceability right back to all raw materials and critical components.
- ※Manual welding parameters printed into the body of the fitting.
- ※After authorization, OEM is accepted.

**Operations Accessories:**

- ※Electrofusion Control box, Pipe cutters, Pipe scrapers, Pipe alignment and Rounding clamps, Generators, Marker pen.

**Attention:**

- ※ Work plan for laying pipes and welding joints site shall be designed in advance.
- ※ Outdoor welding is prohibited in rainy days.
- ※ Before welding, need the injection Roughness &Clean &Remark.
- ※ After 24hours welding, need pressure testing, and pipeline air discharging.

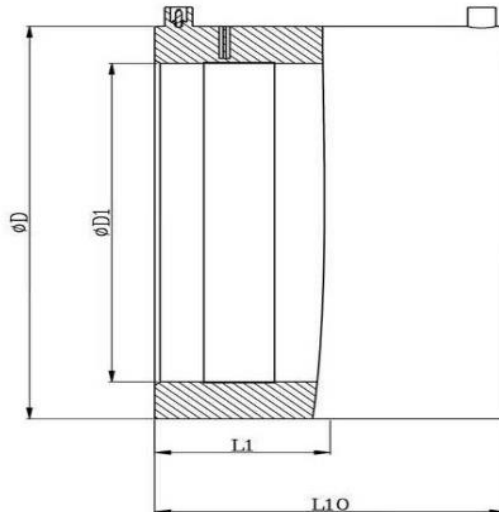

Reference No. and dimensions(mm):

Ref.No.	Fitting size	L10	L1	D	D1	SDR range	Fusion time	Cooling time	Weight/Unit/kg
WS250	250	21	10.5	292	250	11	39.5v/1300s	30min	3.890

**Comments:**

Check that both pipes and fitting to be joined are compatible, only compatible materials should be joined together. Check PN and SDR rating marked on fitting and compare with that of the pipe. If in doubt, seek advice from our manufacturer, Correct installation procedures should be followed.

Packing: 8pcs per carton. The carton size: 59\*58\*45cm N.W.:31.12kgs G.W.:32.62kgs